

Installation Guide

1. Ensure hot and cold water supplies are of equal pressure and volume.
2. Flush pipe-work fully BEFORE installation of valve.
3. Fit in-line filters to both hot and cold supplies.
4. Firmly fix mixing valve to mounting board. Allow 48 - 58mm from this mount to the outer surface of the finished shower wall (43 - 53mm for 215R Retro Control). Valve must be in the vertical position with the outlet at the top.
5. Fit inlet and outlet pipes – **H & C** marked on the valve.
6. Slip on cover-dome (taking care not to damage the sealing o'ring).
7. Attach fascia plate (fit foam ring if required - gap at bottom). Avoid any distortion of plate through over-tightening.
8. Push on indicator plate – TOPLISS at top.
9. Attach lever and tighten grub screw (use 2.5mm Allen key).

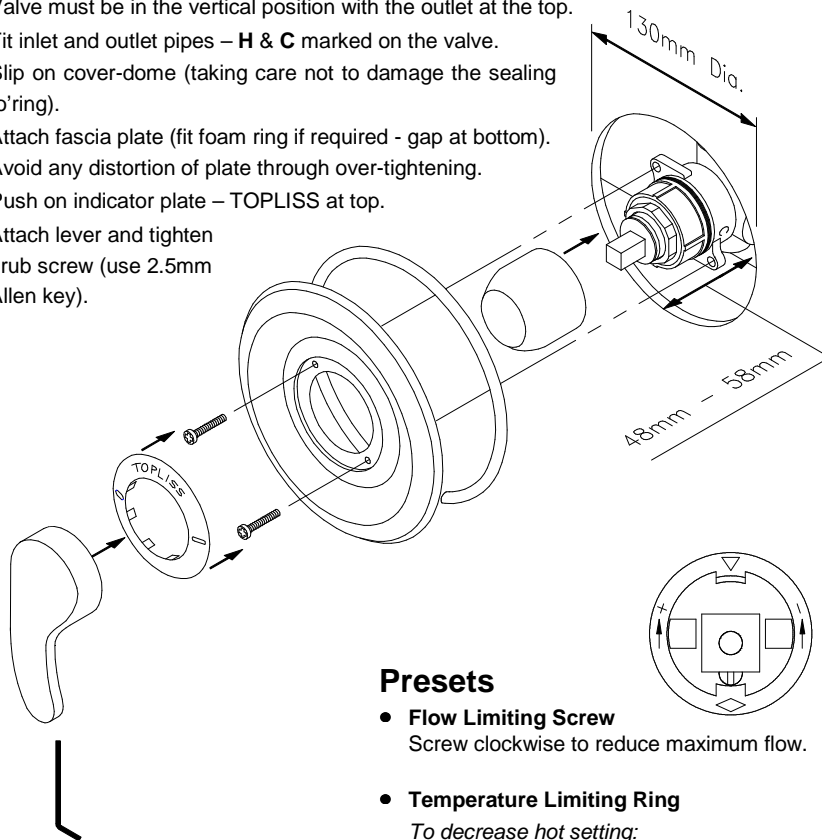

Presets

- **Flow Limiting Screw**
Screw clockwise to reduce maximum flow.
- **Temperature Limiting Ring**
To decrease hot setting:
Remove red ring and turn **anti-clockwise**.
(Full flow cold is maintained)
To decrease cold setting:
Remove red ring and turn **clockwise**.
(Full flow hot is maintained)
Middle position - line up diamond at 6 o'clock mark on green base.

Notes:

- Lag system if likelihood of frost damage.
- Inspect total system for leaks with the valve in the on and off positions.
- If cartridge retaining nut is removed **it must be re-torqued at 10 - 12Nm** (8 - 9 lb/ft) to pre-tension the cartridge and prevent the handle drooping in operation.

Instructions for Retro-fit

The ADS40 Adaptor Kit provides all the special components necessary to replace a TB2 to TB9 valve using existing pipework. Minor pipe realignment may be necessary however. **(Note: minimum 2m head required).**

Check overleaf for anticipated flow rates. Lower flow than ELP models may be noticed.

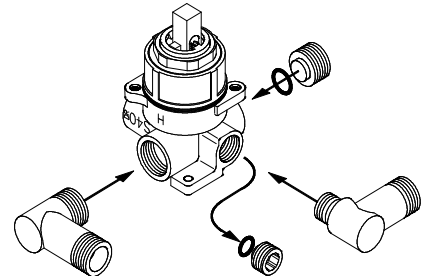

1. Remove 3/8" BSP plug from valve (10mm Allen key)
2. Fit 1/2" BSP plug (c/w o'ring) into the cold inlet ("C").
3. Assemble and seal inlet adaptors as per diagram or to suit particular pipe-work.
4. A standard 15mm crox hex nipple will usually be required for the outlet.
5. Follow main installation guide.

NOTE: If using the larger Retro-fit Fascia, wall depth is 43 - 53mm (not 48 - 58 mm). Usually a 5 - 10mm packer between valve-base and mounting plate is all that will be required.

Parts List

4001	Body	4011	Plug (1/2") O Ring
4002	Cartridge	4051	Fascia
4003	Cartridge Retaining Nut	4052	Foam Gasket
4004	Dome Cover O Ring	4053	Indicator Plate
4005	Cold Plug (3/8" BSP)	4054	Dome Cover
4006	Cold Plug (3/8") O Ring	4055	Lever
4007	Fascia Fixing Screw	4056	Lever Grub Screw
4008	Cold Inlet Adaptor	4057	Foam Wall Seal
4009	Hot Inlet Adaptor	4071	215 Retrofit Fascia 175mm
4010	Plug (1/2" BSP)		

